

Special points  
of interest:



Find US on  
FACEBOOK

Inside this issue:

The Birth of Jesus	1
Citizen of the Year	2
Ribbon Cutting	3
2020 Board of Directors	3
2020 New Members	4
Letter from Open Door	5
Upcoming Events	6
Event Information	7
Shop Local Events	8
Jeff's Toy Challenge	9
Chamber Members	10-11
Opportunities for 2021	12



# Nappanee Chamber Of Commerce



Volume 10, Issue 12

December 2020

## For Unto Us a Child is Born

### *The Birth of Jesus* *Luke 2 NIV*

<sup>1</sup> In those days Caesar Augustus issued a decree that a census should be taken of the entire Roman world. <sup>2</sup> (This was the first census that took place while Quirinius was governor of Syria.) <sup>3</sup> And everyone went to their own town to register.

<sup>4</sup> So Joseph also went up from the town of Nazareth in Galilee to Judea, to Bethlehem the town of David, because he belonged to the house and line of David. <sup>5</sup> He went there to register with Mary, who was pledged to be married to him and was expecting a child. <sup>6</sup> While they were there, the time came for the baby to be born, <sup>7</sup> and she gave birth to her firstborn, a son. She wrapped him in cloths and placed him in a manger, because there was no guest room available for them.

<sup>8</sup> And there were shepherds living out in the fields nearby, keeping watch over their flocks at night. <sup>9</sup> An angel of the Lord appeared to them, and the glory of the Lord shone around them, and they were terrified. <sup>10</sup> But the angel said to them, "Do not be afraid. I bring you good news that will cause great joy for all the people. <sup>11</sup> Today in the town of David a Savior has been born to you; he is the Messiah, the Lord. <sup>12</sup> This will be a sign to you: You will find a baby wrapped in cloths and lying in a manger."

<sup>13</sup> Suddenly a great company of the heavenly host appeared with the angel, praising God and saying,

<sup>14</sup> "Glory to God in the highest heaven, and on earth peace to those on whom his favor rests."

<sup>15</sup> When the angels had left them and gone into heaven, the shepherds said to one another, "Let's go to Bethlehem and see this thing that has happened, which the Lord has told us about."

<sup>16</sup> So they hurried off and found Mary and Joseph, and the baby, who was lying in the manger. <sup>17</sup> When they had seen him, they spread the word concerning what had been told them about this child, <sup>18</sup> and all who heard it were amazed at what the shepherds said to them. <sup>19</sup> But Mary treasured up all these things and pondered them in her heart. <sup>20</sup> The shepherds returned, glorifying and praising God for all the things they had heard and seen, which were just as they had been told.



## 2019 Annual Award Recipients

### Larry Mullet named 2019 Citizen of the Year



Monday evening November 2<sup>nd</sup> the Nappanee Area Chamber of Commerce honored Larry Mullett as the 2019 Citizen of the year! The Chamber awards a Citizen of the year each year at their annual awards dinner. With COVID this year the Chamber hosted the small event of 20 people social distancing and wearing masks at the Nappanee Center. Mr. Mullett's family was in attendance as well as Mayor Phil Jenkins, several Chamber board members and members of the community.

"The Citizen of the Year award is more than just a title, an annual thing we do, or another routine award given to the most popular person in the City. This award recognizes the spirit of a great citizen. It was once quoted,

"To be a good citizen it's important to be able to put yourself in other people's shoes and see the big picture." Jeff Kitson, Executive Director of the Nappanee Area Chamber of Commerce said.

Kitson added "This describes who we are honoring tonight. Someone who puts others first for the betterment of themselves, their community, and county. A standout citizen-selfless, resilient, and servant focused. This award is a statement of pride and gratefulness to a special individual who consistently demonstrates excellence in leadership and makes significant contributions to the welfare of the community. Larry Mullett fits these criteria to a T. He has given freely of his time, energy, and resources to contribute growth, stability and overall betterment of our city."

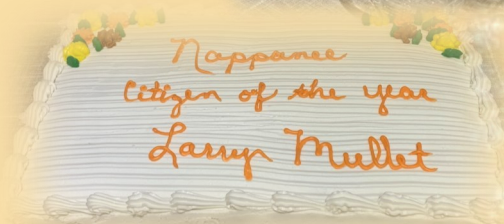





We had a Ribbon Cutting at Brady Klotz Agency on Wednesday, November 11 at 10:30 am. We're so glad he decided to locate his business in Nappanee! He is located at 156 South Main Street, Suite A.

### 2020 Chamber Board of Directors

**Rod Hooley**, Lake City Bank, President

**Ben Leavitt**, Salem Insurance, Vice President

**Donna Persing**, Apple Festival Director, Treasurer

**Becky Cappert**, The Barns at Nappanee

**Brian Yoder**, Kountry Wood Products

**Courtney Oberholzer**, 1st Source Bank

**David Kauffman**, Edward Jones

**Denny Miller**, Kountry Cabinets & Home Furnishings

**Ken Cook**, Burnworth-Zollars Chrysler Dodge JEEP Ram

**Ken Mullet**, Business Networking Group Representative

**Michelle Myers**, Vintage Haus

**Mike DeCola**, Coppes Commons

**Scot Croner**, Wa-Nee Schools

***We would like to thank all of our Chamber board members for their commitment to the Chamber and the Nappanee Community!***



# *2020 New Members*

*Amish Inn*

*Beacon Health Foundation*

*Brady Klotz Agency*

*Brea's Pet Services & Photography*

*Elkhart County Health Department*

*Everence Financial*

*Fahlbeck Properties*

*Final Phase Electric Company*

*Miller Poultry*

*New Paris Telephone*

*Pro IT Solutions*

*The Barns at Nappanee*

*Trilogy HealthWorks LLC*

*US Rod Manufacturing*





## Letter from Open Door

As the holidays approach, we are reminded that we belong to 2 terrific communities. We are thankful that we at Open Door can help our neighbors through this unprecedented time. The Directors and the staff of Nappanee Open Door would like to extend our warmest thanks to the constituents of Nappanee and Wakarusa. Over the year, we have serviced 950 families with food once or twice a month. We have helped 58 families with their NIPSCO or rent bills. None of this could transpire if it weren't for the churches and the good people of our community. Thank you for your continued support! May you be blessed throughout this coming year.

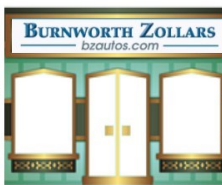

### SHOP LOCAL THIS CHRISTMAS



### EMBRACE THE PACE

Looking for Christmas gifts and aren't sure what to get? The Chamber has gift certificates available that can be used at Nappanee businesses.



# UPCOMING EVENTS

Page 6



<b>Dec 3</b>	<b>Hoosier Hospitality ServSafe Class at Nappanee Center</b>
<b>Dec 4-5</b>	<b>A Coppes Christmas</b>
<b>Dec 11</b>	<b>Countryside Nite Out</b>
<b>Dec 12</b>	<b>Breakfast with Santa ~ The Barns at Nappanee</b>
	<b>FCDC Christmas Jubilee</b>
<b>Dec 24</b>	<b>Chamber &amp; City Offices Close at Noon <i>Christmas Eve</i></b>
<b>Dec 25</b>	<b>Chamber &amp; City Offices Closed <i>Christmas Day</i></b>
<b>Dec 31</b>	<b>Chamber &amp; City Offices Close at Noon <i>New Year's Eve</i></b>

## 2021

<b>Jan 1</b>	<b>Chamber &amp; City Offices Closed <i>New Year's Day</i></b>
<b>Jan 18</b>	<b>Chamber &amp; City Offices Closed <i>Martin Luther King Day</i></b>
<b>Jan 27</b>	<b>Hoosier Hospitality ServSafe Class at Nappanee Center</b>
<b>Feb 15</b>	<b>Chamber &amp; City Offices Closed <i>President's Day</i></b>
<b>March 29</b>	<b>Annual Awards Dinner at Sammlung Platz</b>
<b>April 2</b>	<b>Chamber &amp; City Offices Closed <i>Good Friday</i></b>
<b>April 29</b>	<b>Hoosier Hospitality ServSafe Class at Nappanee Center</b>
<b>May 31</b>	<b>Chamber &amp; City Offices Closed <i>Memorial Day</i></b>
<b>June 15</b>	<b>18th Annual Joint Chamber Golf Outing</b>
<b>July 5</b>	<b>Chamber &amp; City Offices Closed <i>Independence Day</i></b>
<b>Aug 12</b>	<b>Hoosier Hospitality ServSafe Class at Nappanee Center</b>
<b>Sep 6</b>	<b>Chamber &amp; City Offices Closed <i>Labor Day</i></b>
<b>Sep 16-19</b>	<b>Nappanee Apple Festival</b>
<b>Nov 11</b>	<b>Chamber &amp; City Offices Closed <i>Veteran's Day</i></b>
<b>Nov 25-26</b>	<b>Chamber &amp; City Offices Closed <i>Thanksgiving</i></b>
<b>Nov 30</b>	<b>Hoosier Hospitality ServSafe Class at Nappanee Center</b>
<b>Dec 24</b>	<b>Chamber &amp; City Offices Close at Noon <i>Christmas Eve</i></b>
<b>Dec 25</b>	<b>Chamber &amp; City Offices Closed <i>Christmas Day</i></b>
<b>Dec 31</b>	<b>Chamber &amp; City Offices Close at Noon <i>New Year's Eve</i></b>



# 2020 THE CENTER FAMILY CHRISTIAN DEVELOPMENT CENTER CHRISTMAS JUBILEE

**WHEN**  
December 12th, 2020  
9a-12p

**WHERE**  
The Center (New building), Gym  
(Former Nappanee Boy's & Girl's Club)  
107 E Marion Street—Nappanee, IN

IN PARTNERSHIP • Salvation Army's Toys for Tots • WaNee  
Community School District • Local Businesses hosting toy  
boxes

**WWW.THECENTERNAPPANEE.ORG**  
**INFO@FCDCIN.ORG**  
**574-773-2149**



## INFORMATION:

**WHO**  
-Live in Wa-Nee District  
-Have a child 0-18 years

**PRE-REGISTRATION  
REQUIRED  
NOV 2-DEC 4**  
-Parent photo ID  
-Birth Certificate's for each  
child  
-Call The Center or send  
registration in at the  
school

**COVID Safety**  
-5 shoppers at a time  
-masks/sanitizer  
-temp check  
-no coffee/donuts  
-wait in cars until called

**2019 FACTS**  
SERVED 403 YOUTH  
140 FAMILIES  
190 VOLUNTEERS  
55 BUSINESSES

Hoosier Hospitality Consulting will offer  
**ServSafe® Food Protection Manager Classes**  
at The Nappanee Center  
302 W. Market Street

December 3<sup>rd</sup> 2020

Enrolling in a ServSafe class is easy! Check out the class dates above,  
and then [visit our website](http://www.hoosierhospitalityconsulting.com) (www.hoosierhospitalityconsulting.com) to  
enroll, or call Erin in our office at 317- 447- 4761, or email her at  
[erin@hoosierhospitalityconsulting.com](mailto:erin@hoosierhospitalityconsulting.com)



Registered ServSafe Proctor  
& Certified ServSafe Instructor

Indiana law requires that all licensed food service establishments have at least ONE  
Certified Safe Food Handler responsible for each physical location.



**Breakfast with Santa**  
The Barns at  
Nappanee  
December 12, 2020  
9:00 am

The morning includes a delicious  
served buffet, Christmas Sing-A-  
Longs, games, story time, a ride on  
the "Candy Cane Express" and of  
course, a visit from Santa!

[Reserve tickets online](#)



**Veni's**  
101 W. Market St. | Nappanee, IN  
(574) 773-4242  
Call us now for special corporate rates and custom programs.



**Since 1996**  
**MILLER'S  
VARIETY STORE**  
"SOMETHING FOR EVERYONE"

**Storewide Christmas Sale!**  
**DEC. 3 & 4 8am - 8pm | DEC. 5 8am - 4pm**  
**10% OFF STOREWIDE**

**Enter Our Drawing With Any Purchase!**

ADULTS	CHILDREN
<b>GRAND PRIZE:</b> 4 Lifetime Chairs	<b>GRAND PRIZE:</b> \$50
<b>2ND PRIZE:</b> Roni Bag	<b>2ND PRIZE:</b> \$40
<b>3RD PRIZE:</b> Coffee Butler	<b>3RD PRIZE:</b> \$30

- Kitchenware & Housewares
- Canning Supplies
- Fabrics & Sewing Notions
- Games & Toys
- L&G Spices
- Rada Cutlery
- Lifetime Tables & Chairs
- Musical Clocks
- Much, Much More!

**8960 N St Rd 19, Etna Green • 800-667-9893**  
Just a few miles south of Nappanee on State Road 19!  
Mon, Tues, Wed, Fri 8-5 • Sat 8-4 • Closed Thurs & Sun



# I'M DREAMING OF A LOCAL CHRISTMAS



## Countryside Nite Out

December 11, 2020  
2:00 pm to Midnight

5 Winners of \$300  
Countryside Cash

Prize winners are required to have 7 or more stamps from the participating stores to be eligible for \$300 Countryside Cash. Get all the details and maps at any of the participating stores.

**These Countryside Shops invite you to shop all night long and SAVE!!!!**

<b>Alpha Building Center</b> 8270 W 1350 N Nappanee, IN 46550 574-773-7787	<b>Creative Cards</b> 137 4B Road Nappanee, IN 46550 574-773-2776 x1	<b>L &amp; J Cycle</b> 25363 CR 54 Nappanee, IN 46550 574-773-5487	<b>Trainview Window &amp; Door</b> 72729 CR 9 Nappanee, IN 46550 574-773-7640
<b>Burkholder Country Store</b> 29999 CR 56 Nappanee, IN 46550 574-773-4279	<b>Daily Bread Market</b> 4133 E County Line Rd. Bremen, IN 46506 574-773-0303	<b>Little Nook Bookstore</b> 13871 N 1050 W Nappanee, IN 46550 574-773-2107	<b>Triple Oak Sales</b> 7134 W 1300 N Nappanee, IN 46550 574-354-1632
<b>Centsible Clothing &amp; More</b> 9720 W 1200 N Nappanee, IN 46550 574-646-2418	<b>Diamond Harness &amp; Sales</b> 10023 W 1350 N Nappanee, IN 46550 574-773-5454	<b>Ruth's Library &amp; Tri-County Electric</b> 234 1st Rd. Nappanee, IN 46550 574-773-2795	<b>UNL Trading Co.</b> 10511 N SR 19 Nappanee, IN 46550 574-646-2078
<b>Country Home Furniture</b> 13778 N 950 W Nappanee, IN 46550 574-773-8908	<b>Heritage Fabrics &amp; General Store</b> 25350 CR 52 Nappanee, IN 46550 574-773-2445	<b>Second Chance Discount</b> 1818 5th Rd Bremen, IN 46506 574-546-2555	<b>Weaver Furniture</b> 6146 W 1350 N Nappanee, IN 46550 574-773-4826
<b>Countryside Vendors</b> 29607 CR 52 Nappanee, IN 46550 574-907-4016	<b>John's Bargain Barn</b> 9962 N SR 19 Nappanee, IN 46550 574-646-9908	<b>Solar Energy Systems</b> 8015 W 1350 N Nappanee, IN 46550 574-773-0546	<b>Weaver's Dutch Country Surplus</b> 22534 CR 50 New Paris, IN 46553 574-831-4927

## 2020 Countryside Nite Out Participants

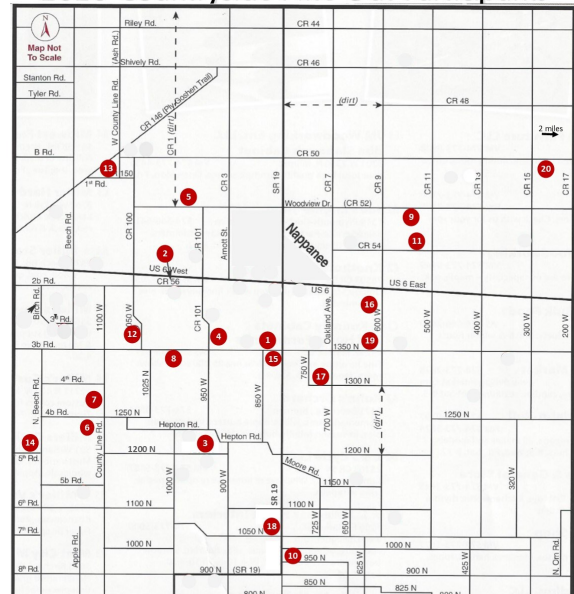

- |                            |   |                                   |
|----------------------------|---|-----------------------------------|
| 1 Alpha Building Center    | 8 Diamond Harness & Sales               | 15 Solar Energy Systems           |
| 2 Burkholder Country Store | 9 Heritage Fabrics & General Store      | 16 Trainview Window & Door LLC    |
| 3 Centible Clothing & More | 10 John's Bargain Barn                  | 17 Triple Oak Sales               |
| 4 Country Home Furniture   | 11 L & J Cycle                          | 18 UNL Trading Co.                |
| 5 Countryside Vendors      | 12 Little Nook Bookstore                | 19 Weaver Furniture               |
| 6 Creative Cards           | 13 Ruth's Library & Tri-County Electric | 20 Weaver's Dutch Country Surplus |
| 7 Daily Bread Market       | 14 Second Chance Discount               |                                   |

SH  P  
LOCAL

THIS CHRISTMAS  
I PLEDGE  
to  
Shop SMALL  
Spend LOCAL  
Eat LOCAL  
Enjoy LOCAL  
and support the local  
businesses that support me  
& my community



*Store Specials & Giveaways / Free Shuttle to Bethlehem Experience Friday*

STORES OPEN UNTIL 9 PM FRIDAY | SHUTTLE TO NATIVITY WALK RUNS 5 - 9 PM FRIDAY  
SPECIALS RUN ALL DAY FRIDAY AND SATURDAY. SEE REVERSE FOR DETAILS.

FOR MORE INFO VISIT [WWW.COPPESCOMMONS.COM](http://WWW.COPPESCOMMONS.COM)

Coppes Commons • 401 E Market St., Nappanee, IN • 574.773.0002



**NEW SHOP NOW OPEN!**

Purchase 3 items and receive a free sample bottle of olive oil

**IN-STORE SPECIALS  
DECEMBER 4 & 5**

VALID FRIDAY & SATURDAY  
DURING INDIVIDUAL SHOP HOURS

Visit [www.coppescommons.com](http://www.coppescommons.com) for hours.

**ENTRY**

Visit every store for a stamp, and you'll be entered to win a prize basket & a \$100 Coppes Commons gift card!

 <p><b>Lera's Rugs</b> Buy one rug, get one 50% off and 25% off solid color Liverpool fabric</p>	 <p><b>Light of Grace</b> 15% off all regular-priced merchandise, enter to win \$100 gift card with a purchase</p>	 <p><b>Dutch Lady Antiques</b> Discounts in select booths</p>	 <p><b>Twist Pretzels</b> Buy a pretzel pocket, get a free original pretzel</p>	 <p><b>Nappanee's Store</b> 10% off your entire purchase</p>
 <p><b>Rocket Science</b> FAMILY BRAIN FREEZE! Four mini ice creams for \$12</p>	 <p><b>Culinary Mill</b> Free take 'n' bake pizza with a \$25 purchase while supplies last</p>	 <p><b>Country Home Star Shoppe</b> Free Christmas tree ornament with a \$25 purchase &amp; sales on select merchandise</p>	 <p><b>The Dutch Kernel</b> 15% off any single item</p>	 <p><b>Artisan Market</b> 10% off your entire purchase &amp; a chance to win a gift basket donated by artisans.</p>

The Coppes Commons merchants are excited to welcome you to their shops for some big giveaways, sales and special guests on the weekend of December 4 & 5! A shuttle will run between Coppes Commons and The Barns, so you can enjoy both the Bethlehem Experience and all the wonderful shoppes have to offer in one evening. [Follow us on Facebook](#) for more details!



# Jeff's 3rd Annual Toy Challenge

## COVID STYLE

It's time for Jeff's 3<sup>rd</sup> Annual Toy Challenge!  
This year he's doing it **COVID STYLE!**

All the toys that we collect will go to **FCDC Christmas Jubilee**.

If you bring **NEW UNWRAPPED TOYS, COATS, HATS, GLOVES, AND STOCKING STUFFERS** to fill the Toys for Tots box, you will receive 1 point for every item you bring in. Please see the list below for suggestions.

### NEW THIS YEAR - COVID STYLE

All the items we collect for our **SENIOR CITIZENS** will be distributed through The Elder Haus and The Center (FCDC).

If you bring **NEW UNWRAPPED SHAMPOO, LOTION, CANDY, PUZZLES**, to fill the Support Our Seniors box, you will receive 1 point for every item you bring in. Please see the list below for suggestions.

**The challenge will end at 4:45 pm on December 9<sup>th</sup>.**

We will try to keep you updated about the donations received on Facebook. Let's make this a fun and exciting way to bring cheer to others in need.

#### ITEMS ESPECIALLY NEEDED

##### FOR KIDS:

- \* Mittens & Snow gloves
- \* Winter coats
- \* Blankets (all sizes)
- \* Perfume/toiletries (teens)
- \* Craft kits
- \* Games/puzzles
- \* Dolls & accessories
- \* Hand held electronic games (school age)
- \* \$15-\$20 Gift cards (teens)
- \* Sports equipment
- \* Sports Team clothing
- \* Children's books

#### ITEMS ESPECIALLY NEEDED

##### FOR SENIORS:

- \* Shampoo
- \* Lotion
- \* Candy
- \* Perfume/toiletries
- \* Crossword Puzzles
- \* Games/puzzles
- \* Word Search
- \* Tylenol
- \* \$15-\$20 Gift cards

All items need to be dropped off at the  
Chamber office: 302 W. Market St.

#### Winner will receive:

A monetary donation in your  
name to the Wa-Nee School of  
your choice.





# 2020 Chamber Members

Page 10

## MANUFACTURING

Alexander Dennis, Inc.  
Aluminum Trailer Co.  
Ayr Cabinet  
Challenger Door  
Commercial Structures Corp.  
Eagle Routing & Laser  
Hochstetler Grain Equipment  
inTech Trailers  
Kountry Wood Products  
Miller Manufacturing Corp.  
Mullet Custom Interior  
Newmar Corporation  
Northern Indiana Axle  
PWI  
Quality Hardwood Sales/UFP  
US Rod

## RETAIL

Alpha Building Center  
Bourbon Street Pizza Co.  
Burkholder Country Store  
Burnworth-Zollars Chrysler  
Dodge Jeep RAM  
Community Business  
Equipment  
Coppes Commons  
CountryHome Furniture  
Culinary Mill Market & Deli  
Daily Bread Market  
E. Newcomer & Son  
Graber's Flooring Studio  
Heritage Fabrics & General  
Store  
Holy Smokes BBQ  
HomeStyle Furniture  
Hunter's Hideaway Bar & Grill  
Jenkins Automotive/NAPA  
John's Butcher Shop  
K.E.Y. Boutique  
Kountry Cabinets  
Light of Grace Book & Gift  
Store  
Little Nook Bookstore  
LJ Wagner Interiors  
Main Street Roasters

Martin's Super Market  
McCormick Motors  
Miller Stove & Fireplace  
Miller's Variety Store  
Mullet's Dining  
My Red Moon  
Nang's Chinese Restaurant  
Nappanee's Bakery & Treat  
Shopee  
Panthers Pizza  
Perfect Twist Pretzels  
Persing Tire & Auto Service  
Plevna Implement Co Nappanee  
Pro IT Solutions  
Rentown Stores, Inc.  
Rite Choice  
Rocket Science Ice Cream  
Schwartz Nylon Harness Shop  
Solar Energy Systems  
Stickley Ace Hardware  
The Barns at Nappanee  
Tractor Supply Co.  
Veni's Sweet Shop  
Verizon Wireless - Russell  
Cellular  
Vintage Haus  
Weaver Furniture Barn

## SERVICE/ PROFESSIONAL

1st Source Bank  
Adams Remco  
ADEC, Inc.  
Amish Inn  
Beacon Health Foundation  
Beacon Medical Group  
Nappanee  
Beer & Slabaugh, Inc.  
Best Insurance Settlement  
Better Business Bureau  
Big Brothers Big Sisters of  
Elkhart County  
Boys & Girls Club  
Brady Klotz Agency—Indiana  
Farm Bureau  
Brea's Pet Services &  
Photography

Center for Hospice Care  
Chiphone FCU  
City Of Nappanee  
CLC International  
Community Foundation of  
Elkhart County  
Community Hospital of Bremen  
CountrySide Inn  
Eastlake 24 Nappanee  
EDC of Elkhart County  
Edward Jones ~ David Kauffman  
Edward Jones ~ Deborah Ayres  
Elkhart County Commissioners  
Elkhart County Convention &  
Visitors Bureau  
Elkhart County Health Dept.  
Everence Financial  
Fahlbeck Properties  
Family Christian Development  
Center  
Final Phase Electric Company  
Get Fit Get Healthy  
Goshen Hospital  
Goshen Health Rehabilitation  
Services  
Gravelton Machine Shop, Inc.  
Gravelton Properties  
GT Properties Eastown Villa  
Hampton Inn  
Heckaman Insurance Agency  
Henschen Oil  
Heritage House  
Hoosier Hospitality Consulting  
Horizon Education Alliance  
Hutsell Chiropractic  
INterra Credit Union  
John Mast Construction  
John's Auto Spa  
Justus Property Management  
Kemp Electric  
KeyBank  
Kindig & Sloat  
Klotz Insurance  
Korhorn Financial Group  
Lake City Bank  
Law Office of Christopher Walter



Lee Anne Stewart Dance School  
 L.O.H Tax Group  
 Loucks & Weaver CPA  
 Main Street Manor  
 MapleTronics  
 Market St. Auto Service  
 Meadows MHC  
 MedStat Nappanee  
 Miller Poultry  
 MJ Finishing  
 Nappanee Family Eyecare  
 Nappanee Noon Kiwanis  
 Nappanee Open Door  
 Nappanee Public Library  
 Nappanee Rotary Club  
 Nappanee Spinal Adjusting  
 Center  
 New Paris Telephone  
 Nephew Pharmacy  
 Newcomer Service

NIPSCO  
 NorthWood Family Dentistry  
 Northwood Family Medicine  
 Nuway Construction  
 OSMC  
 Osteopathic Family Clinic-  
 Nappanee  
 O.T. Works/The Therapy  
 Playce  
 PDS  
 Phil Hahn & Associates  
 Physicians Health Plan  
 Premiere Signs  
 R. Yoder Construction, Inc.  
 Reliance Construction, Inc.  
 Salem Insurance  
 Schrock Financial  
 Shamrock Motel  
 Sylvia Benjamin State Farm  
 Insurance

The Goshen News  
 The Hall at Oakland Park  
 The Papers, Inc.  
 Thompson Lengacher &  
 Yoder Funeral Home  
 Topping Dental Group  
 Topp-Notch Construction  
 Trinity HealthWorks LLC  
 United Way of Elkhart County  
 Visit Nappanee  
 Visiting Angels  
 WaNee Community Schools  
 Weaver Home Improvement &  
 Construction  
 Wilson Financial Group  
 Windsor Legacy LLC  
 WSBT TV 22  
 Yoder, Ainlay, Ulmer &  
 Buckingham, LLP  
 Yoder-Stutzman, Inc.

# MERRY CHRISTMAS

## Mission Statement

***The mission of the Nappanee Area Chamber of Commerce is to help make Nappanee an industry leading city with innovative businesses, a great community in which to live with abundant resources, and a wonderful tourist destination where visitors can "Embrace the Pace".***

## Our Vision Statement

***The vision of the Nappanee Area Chamber of Commerce is to create an environment for people to start or relocate businesses, to work, to worship, and to live in our community and to ignite passion to serve our community with heart.***



# Opportunities for 2021



Training with

To sign up,  
please contact Gloria Moser  
at [Gmoser@mapletronics.com](mailto:Gmoser@mapletronics.com) or  
574.534.2830 x 153

## 2021 Classes at Nappanee Chamber

CLASS TITLE	DATES	TIME
QuickBooks Level 1	March 16 & 18	5:30-9 pm
QuickBooks Level 2	May 25 & 27	5:30-9 pm
Outlook Tips & Tricks	January 20 March 24 May 12	3-5 pm
Excel Level 1	January 12 & 14 April 13 & 15	5:30-9 pm
Excel Level 2	March 2 & 4 May 18 & 20 June 22 & 24	5:30-9 pm
Word Level 2	March 23 & 25	5:30-9 pm
Teams	March 9 April 27 June 22	3-5 pm

**Hoosier Hospitality Consulting will offer  
ServSafe® Food Protection Manager Classes  
at The Nappanee Center  
302 W. Market Street**

**January 27<sup>th</sup>, April 29<sup>th</sup>, August 12<sup>th</sup>, November 30<sup>th</sup>, 2021**

Enrolling in a ServSafe class is easy! Check out the class dates above,  
and then [visit our website](http://www.hoosierhospitalityconsulting.com) ([www.hoosierhospitalityconsulting.com](http://www.hoosierhospitalityconsulting.com)) to  
enroll, or call Erin in our office at 317- 447- 4761, or email her at  
[erin@hoosierhospitalityconsulting.com](mailto:erin@hoosierhospitalityconsulting.com)



Registered ServSafe Proctor  
& Certified ServSafe Instructor

Indiana law requires that all licensed food service establishments have at least ONE  
Certified Safe Food Handler responsible for each physical location.

Nappanee Chamber Of Commerce  
302 W. Market Street  
Nappanee, IN 46550